

MODERN SAILING GLOBAL DESTINATIONS PRESENTS



Southern THAILAND & Andaman Islands Sailing Adventure

March 19 -28, 2026



+1 (415) 331-8250 | +1 (800) 995-1668 | modernsailing.com



Join our Sailing Adventure in Thailand!

Join **Modern Sailing School & Club** for an sailing adventure voyage as we chart a course through the heart of the **Andaman Sea and Phuket in Thailand**. From **March 19 to 28 of 2026**, under the expert guidance of Captain Robert Bivin, our Trip Leader, and Captain Eric Wittig, two of our most experienced captains, you'll sail through Thailand's iconic islands — a sailor's dream of vibrant coral reefs, dramatic limestone karsts, and hidden lagoons carved by time and tide.

Ahead lies a journey of discovery, where a beautiful horizon awaits you with every sunrise and every sunset invites camaraderie under the stars.

For more information and to reserve your spot, contact Modern Sailing School & Club.

- Call: (415) 331-8250
- Email: globaldestinations@modernsailing.com



Reserve Your Adventure

Come join us aboard one of our expertly chosen yachts. Choices for all experience levels:

- **Skippered Club Boats:** Skippered by seasoned Modern Sailing US Coast Guard Licensed captains, these floating havens are a blend of comfort and adventure. Reserve your cabin, solo or with a partner. No sailing experience required. All cabins will be hosted on catamarans.
- **Bareboats:** For seasoned sailors, lead your crew through the wonders of the the Andaman Sea, Thailand while enjoying the support of the Modern Sailing flotilla. To take the helm as a Bareboat captain ASA 104 - Bareboat Cruising or equivalent experience will be required.

Reserve your Cabin or Bareboat now and set sail for a unforgettable sailing adventure with Modern Sailing School & Club.

CABIN AND BAREBOAT PRICES

Occupancy Type	Early Bird Pricing** 	Standard Pricing
Cabin - Single Occupancy on a Skippered Catamaran	\$9,995	\$10,750
Cabin - Double Occupancy on a Skippered Catamaran	\$10,495	\$11,282
Bareboat - Sunsail 454L Catamaran 4 Cabin Classic Edition w. Lounge	\$21,995	\$23,645
Bareboat - Sunsail 424 Catamaran 4 Cabin Premier Edition	\$21,195	\$22,785
Bareboat - Sunsail 41 Monohull 3 Cabin Classic Edition	\$11,495	\$12,357

A **deposit of 50%** of your cabin or bareboat choice is due at time of enrollment. Remaining balance is due November 19th, 2025.

****Early Bird Pricing** ends August 31st, 2025.



Why Sail Thailand with Modern Sailing?

Prepare for an incredible experience with our 2026 Thailand flotilla! The Andaman Sea is an unparalleled sailing destination, offering vast natural beauty. Our carefully crafted itinerary takes you to some of the most stunning locations this region has to offer.

Beyond the breathtaking scenery, we anticipate encountering incredible wildlife, like many types of colorful fish, sea turtles and rays. The Andaman Sea is teeming with unique biodiversity, and our flotilla provides firsthand opportunities to experience this thriving underwater world.

A **Modern Sailing flotilla** offers unforgettable global discoveries, opening doors to the world's most spectacular cruising grounds. This isn't just a trip; it's a chance to explore pristine coastlines, and enhance your skills as a confident sailor.

You can choose a tailored sailing experience: Reserve a **cabin** on a captained catamaran for an immersive learning journey guided by experienced skippers, or embark on a **bareboat** adventure within the flotilla, enjoying independent exploration with the full support and camaraderie of the group.





...Why Sail Thailand with Modern Sailing? (continued)

Our commitment to expert guidance and continuous learning sets us apart. Our experienced ASA and Coast Guard Certified captains provide ongoing support and guidance throughout your voyage. You'll be able to improve on valuable navigation skills, discover anchorages, and deepen your understanding of the local culture and environment.

This supportive environment also fosters a strong sailing community, allowing you to connect with fellow enthusiasts, forge lasting friendships, and share unforgettable experiences while exploring breathtaking destinations together.

This Thai flotilla is classified as a **Level 2 sailing destination** by The Moorings charter company, meaning it offers clear hazards requiring constant vigilance, good seamanship, and careful attention to charts.

As a bareboat skipper, this requires at least an ASA 104 certification or equivalent.

On our skippered boats, our US Coast Guard certified captains are onboard to support all skill levels, ensuring a rewarding voyage for everyone.

Our itinerary includes sailing legs of varying distances, up to 20 nautical miles, providing both exciting passages and more relaxed sails. We'll explore secluded bays, marvel at dramatic limestone karsts, hidden lagoons, and immerse ourselves in the vibrant Thai culture. Evenings will be spent enjoying sundowners and sharing stories under the stars. Our Trip Leader will adapt the itinerary as needed based on weather and other factors, ensuring a safe and enjoyable experience. This is more than just a sailing trip; it's an opportunity to create lasting memories and experience the magic of Thailand's islands.





THE ITINERARY*

Thailand, Andaman Sea March 19th - 28th 2026



Day 1 : Arrival at base, check-in and welcome reception (no sailing)

Day 2 : Ao Po Grand Marina - Koh Hong ~ 10nm (~2h)

Day 3: Koh Hong - Railay Beach , West ~28nm (~5.5h)

Day 4: Railay Beach, West - Khlong Dao Beach ~25nm (~5h)

Day 5: Khlong Dao Beach - Koh Phi Phi ~19nm (~4h)

Day 6 : Koh Phi Phi (Layover day)

Day 7: Koh Phi Phi - Nai Harn Beach ~32 nm (~6h)

Day 8: Nai Harn Beach - Koh Yao Yai ~25nm (~5h)

Day 9: Koh Yao Yai - Koh Nakha Yai ~7nm (~1h)

Day 10: Koh Nakha Yai - Ao Po Grand Marina ~1nm (<.5h)

*Upon the Trip Leader's judgment, the itineraries are subject to change



DAY 1: Arrival on Phuket and Charter-base at **Ao Po Grand Marina**

Captains briefing @ 10:00am

Vessel Boarding @ 3:00pm

Welcome Reception @ 5:00pm

Station: Docked in Marina.

Things to do: Welcome reception, boat briefings, provisioning, and settling into your cabin or bareboat.



DAY 2: Sail to **Koh Hong** from Ao Po Grand Marina: ~10-12 nautical miles / 2-3 hours

On this day, we'll set sail from Ao Po Grand Marina for the stunning Koh Hong, a true gem of the Andaman Sea. This island is the centerpiece of a beautiful marine area, known for its iconic lagoon and dramatic limestone formations.

Koh Hong (meaning "room island" in Thai, referring to its enclosed lagoon) offers a delightful foray into the wonders of nature, with superb swimming and the chance to explore its unique tidal lagoon.

Station: Anchorage in sand.

Dinghy: You'll typically beach your dinghy on the sand or at designated points for access to the lagoon.

Things to Do:

- Swimming and snorkeling are the main attractions. The clear waters offer fantastic visibility.
- Explore the "Hong" (lagoon): Dinghy or kayak into the spectacular inner lagoon along a narrow entrance, a truly magical experience, especially at high tide.
- Relax on the beach: Enjoy the crescent-shaped main beach with its soft white sand and stunning backdrop of towering cliffs.
- Hiking: A short nature trail leads to a viewpoint offering panoramic vistas of the surrounding islands.

Facilities: Limited facilities are available on the main beach, often including restrooms and a small shop for drinks and snacks. There are no facilities for yachts beyond the mooring/anchoring spots.

Dining : We'll primarily dine aboard and enjoy the breathtaking views from our boats.



Koh Hong Island and Lagoon

Located north of Krabi, Koh Hong is part of a group of islands known for their distinctive limestone cliffs and crystal-clear emerald waters. The main draw is its spectacular lagoon, accessible via a narrow opening that leads into a hidden "room" surrounded by sheer cliffs. This area is a protected national park, ensuring its pristine condition and abundant natural beauty.



DAY 3: Sail to Railay Beach, West
from Koh Hong: ~10-12 NM / 2-3h)

Railay Beach, a world-renowned destination famous for its stunning limestone cliffs, pristine sands, and vibrant atmosphere. This unique peninsula, accessible only by boat, offers an unforgettable Andaman experience.

Station: Anchoring in sand.

Dinghy: You'll typically beach your dinghy on the sand.

Things to Do:

- Rock Climbing, this is a global mecca for rock climbing, with routes for all skill levels.
- Explore Phra Nang Cave Beach: A short walk through a scenic pathway leads to the stunning Phra Nang Cave Beach, famous for its unique Princess Cave and beautiful limestone formations.
- Enjoy the soft white sands, and witness breathtaking sunsets over the Andaman Sea from the beach or one of the beachfront bars.

Facilities: There are a good range of facilities, including restaurants, bars, small shops, and guesthouses set back from the beach.

Dining: We'll have the option to dine ashore at one of the many beachfront restaurants or cafes, savoring both Thai and international cuisine.

Railay Beach, West

This spectacular peninsula in Krabi is famed for its towering limestone cliffs that cut it off from the mainland, making it exclusively accessible by boat. It offers a unique blend of adventure, natural beauty, and a laid-back atmosphere, drawing visitors from around the globe.





DAY 4: Sail to Khlong Dao Beach
from Railay Beach: ~15-18 NM / 3-4h

Khlong Dao Beach on the island of Koh Lanta is a long, sweeping sandy beach and is known for its relaxed atmosphere, family-friendly waters, and stunning sunsets.

Station: Anchorage in sand.

Dinghy: You'll typically beach your dinghy on the sand.

Things to Do:

- Enjoy the expansive, soft sands of this beach, perfect for long walks, sunbathing, and swimming in the calm, shallow waters and watching sunsets
- A range of relaxed beach bars, restaurants, and small shops line the road just behind the beach,
- Treat yourself to a traditional Thai massage right on the beach.

Facilities: Khlong Dao Beach has a good array of facilities, including numerous beachfront restaurants, bars, resorts, and convenient stores accessible from the road.

Dining: Dine ashore options are available, to enjoy fresh seafood and authentic Thai dishes, or opt to dine aboard.

Khlong Dao Beach, Koh Lanta

Khlong Dao Beach is one of the most popular and accessible beaches on Koh Lanta, known for its gentle slope into the sea, making it very safe for swimming. It offers a perfect blend of convenience with a relaxed, less developed atmosphere than some other major Thai tourist spots, providing a genuine island experience.





DAY 5: Sail to Koh Phi Phi from Khlong Dao Beach: ~15-20 NM / 3-4h

Koh Phi Phi is a world renowned iconic destination in the Andaman Sea. This stunning archipelago, is famous for its dramatic limestone cliffs, vibrant nightlife, and breathtaking bays.

Station: Anchorage in sand.

Dinghy: There are limited formal dinghy docks. You'll typically beach your dinghy on the sand in designated areas, often near longtail boat queues.

Things to Do:

- Explore Maya Bay: While often crowded, this famous bay on Phi Phi Leh (where The Beach was filmed) is stunning.
- Snorkeling and Diving: Phi Phi boasts incredible underwater visibility and vibrant coral reefs teeming with marine life, making it a premier spot for snorkeling and diving.
- A challenging but rewarding hike offers panoramic views of the narrow isthmus connecting the two main parts of Phi Phi Don.
- Longtail Boat Tours: Consider taking a local longtail boat tour to explore surrounding islands and hidden lagoons.

Facilities: Tonsai Village, has extensive facilities including numerous restaurants, bars, guesthouses, dive shops, ATMs, and convenience stores.

Dining: We'll have a wide array of choices to dine ashore at one of Phi Phi's many restaurants, ranging from local Thai eateries to international cuisine. Alternatively, we can dine aboard for a more secluded experience away from the bustling main areas.

Koh Phi Phi

The Phi Phi Islands, consisting of Phi Phi Don (the main inhabited island) and Phi Phi Leh, are iconic for their dramatic karsts, turquoise waters, and lush green cliffs. Despite their popularity, the sheer beauty of their bays and the lively atmosphere make them an unforgettable stop on any Andaman Sea itinerary.





Day 6: LAYOVER DAY on Koh Phi Phi (No Sailing)

Koh Phi Phi offers a diverse range of activities to keep you entertained from dawn till dusk, and well into the night:

- **Snorkeling & Diving:** You can easily rent snorkeling gear and explore the vibrant coral reefs right off many beaches. Or Diving: For certified divers, Phi Phi is a world-class destination. There are numerous dive shops offering day trips to sites like Hin Muang, Hin Daeng, or the King Cruiser Wreck, teeming with diverse marine life, including leopard sharks, barracudas, and intricate coral formations.
- **Island Hopping and Exploration by Boat:** Rent a private longtail boat or join a group tour to explore the surrounding islands and hidden gems.
 - Maya Bay: Visit the iconic Maya Bay (on Phi Phi Leh) for its stunning scenery.
 - Pileh Lagoon: A breathtaking emerald lagoon surrounded by towering limestone cliffs.
 - Viking Cave: Explore this ancient cave on Phi Phi Leh with its historical wall paintings and swiftlet nests.
 - Monkey Beach: A small cove inhabited by playful monkeys (observe from a safe distance).
- **Hiking to the Viewpoint:** Ascend to the famous Phi Phi Viewpoint for panoramic views of Tonsai Village, Tonsai Bay, and Loh Dalum Bay.



- **Nightlife:** Koh Phi Phi is well-known for its vibrant and energetic nightlife, particularly centered around Tonsai Beach and Loh Dalum Bay.
 - **Beach Bars and Fire Shows:** As dusk settles, many beach bars along Tonsai and Loh Dalum beaches come alive with music, cheap drinks, and spectacular fire shows, and feature live bands playing a mix of international hits and reggae music.
 - **Nightclubs:** For those looking to dance, there are several larger venues that play electronic dance music and host DJ sets, keeping the party going until the early hours.

DAY 7: Sail to Nai Harn Beach
from Koh Phi Phi: ~25-30 NM / 5-6h

Nestled on the southwestern tip of Phuket, Nai Harn Beach is a favorite among locals and discerning travelers alike for its picturesque setting, excellent swimming conditions, and stunning sunsets.

Station: Anchorage in sand.

Dinghy: You'll typically beach your dinghy on the sand

Things to Do:

- For Sunset viewing, find a spot on the beach or at one of the hillside restaurants for an unforgettable view.
- A short drive or dinghy ride away, Promthep Cape is Phuket's most famous viewpoint, offering panoramic vistas of the Andaman Sea, especially popular at sunset.
- Discover nearby Beaches such as Ao Sane Beach or Ya Nui Beach.

Facilities: Nai Harn Beach has a good range of facilities, including numerous local restaurants, convenience stores, and some resorts set back from the main beach. ATMs are also available nearby.

Dining: We'll have a delightful selection of choices to dine ashore at Nai Harn, with many excellent Thai restaurants serving fresh seafood and authentic dishes.

Nai Harn Beach, Phuket

Nai Harn Beach is consistently rated as one of Phuket's best beaches. Located near the island's southernmost point, it's a deep bay often used by local fishing boats. Its clean water and soft sand, coupled with a less commercialized feel than some northern beaches, make it a peaceful haven. It's a popular spot for both locals and expatriates seeking a tranquil environment.





DAY 8: Sail to Koh Yao Yai

from Nai Harn Beach: ~15-20 NM / 3-4h

Koh Yao Yai, a large, yet relatively undeveloped island offers a refreshing contrast to the more bustling tourist hubs, providing a glimpse into traditional Thai island life amidst its unspoiled landscapes, rubber plantations, rice paddies, and a genuine local charm.

Station: Anchorage in sand.

Dinghy: You'll typically beach your dinghy on the sand.

Things to Do:

Rent a scooter or bicycle to explore the island's interior, passing through rubber plantations, local farms, and experience villages and the vibrant local markets to see fresh produce and interact with islanders.

Facilities: Koh Yao Yai has developing infrastructure with a growing number of resorts and guesthouses, local shops, pharmacies, and ATMs, primarily along the main roads. It's less developed than Phuket, offering a more rustic experience.

Dining: We'll have wonderful opportunities to dine ashore at charming local restaurants, or dine aboard.

Koh Yao Yai

Part of the Phang Nga Bay archipelago, Koh Yao Yai (meaning "Big Long Island") is celebrated for its authentic charm and slower pace of life compared to its more famous neighbors. It remains largely agricultural, offering a peaceful retreat with incredible views of the dramatic limestone karsts that dot the surrounding bay. Its proximity to Phuket and Krabi makes it an accessible yet wonderfully unspoiled destination.



Weather & Conditions

Phuket, Thailand offers great weather in March ahead of the rainy season, making it an exceptional destination for sailors. During this month, **daytime temperatures** usually reach a warm **90°F**, while **nights cool down to a pleasant 77°F**—perfect for basking in the sun and enjoying gentle, breezy evenings. Although short rain showers may occur, they are generally infrequent and provide a refreshing break from the tropical heat.

March in Phuket falls toward the end of the dry season, with calm seas and lush, vibrant landscapes all around. Expect abundant sunshine with over 12 hours of daylight each day, allowing you to make the most of your time on the water and explore the scenic coastline. The **sea temperature** hovers around a comfortable **84°F**, inviting you to swim, snorkel, and dive into the sparkling waters of the Andaman Sea.

Wind Conditions, Currents & Tides

In March, Phuket enjoys predominantly gentle **northeast winds**, generally blowing at **8 to 15 knots**, creating pleasant and manageable sailing conditions. Gusts are rare but may occasionally reach up to 20 knots, providing just enough challenge for those looking to hone their sailing skills.

The **currents** around Phuket **are typically mild**, though they can become more noticeable near headlands and in narrow channels, so attentive navigation is important. **Tidal ranges** in this region average **around 8 feet** (2.4 meters), making careful anchoring and mooring especially important to ensure your vessel's safety.

Weather forecast

In Phuket, daily marine weather updates are broadcast by the Thai Meteorological Department, with reports available in Thai and English. You can tune in to **FM 106 MHz for regular weather bulletins**, typically aired in the early morning and throughout the day. For sailors, up-to-date forecasts and marine warnings are also available on VHF channel 67, with additional information and clearance services provided on channels 16 and 71. Phuket's main weather station delivers detailed forecasts covering the Andaman Sea and surrounding islands, helping ensure safe and informed navigation for all mariners.

Mooring, Buoying and Local Navigation

Phuket, Thailand, uses the IALA-A system, similar to Europe and most of Asia. Red cylindrical buoys with even numbers mark the port (left) side of channels when entering from the sea, while green conical buoys with odd numbers indicate the starboard (right) side. Major channels around Phuket, including approaches to popular marinas and harbors, are generally well marked with buoys and navigation aids. However, in some less frequented areas, buoyage may be sparse or limited to a few scattered markers. Additional and up-to-date information on local navigation, mooring, and buoy placement will be shared during the skipper briefing.

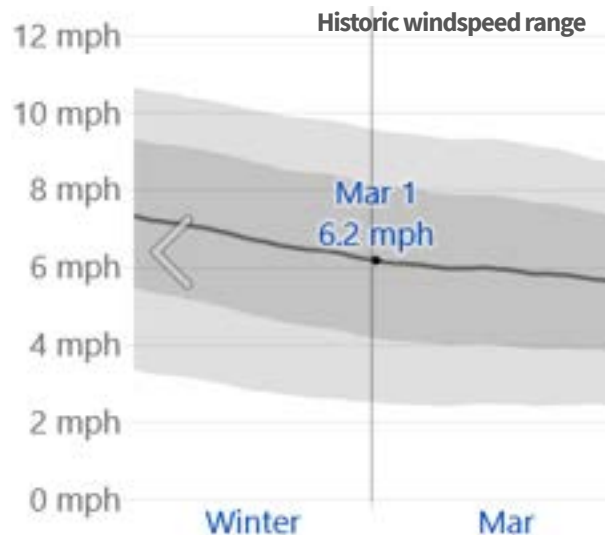



BOATS 1 & 2 - Club Skippered Moorings 4500L (Lounge), 4-Cabin Catamaran

Winner of the 'Best Charter Boat' category in Cruising World's 2017 'Boat of the Year' competition, this innovative mid-size catamaran from renowned boat builders Robertson & Caine takes style, comfort, and performance to the next level. The new Moorings 4500 features four spacious staterooms, all with en-suite baths – and delivers the solid performance expected from this world-renowned line of catamarans, and more – for an unrivaled mid-size catamaran charter experience. The 4500 boasts an interior volume and spaciousness typically found on larger yachts. An updated, sleek exterior design featuring expansive windows also greatly impacts the interior saloon, creating panoramic views.

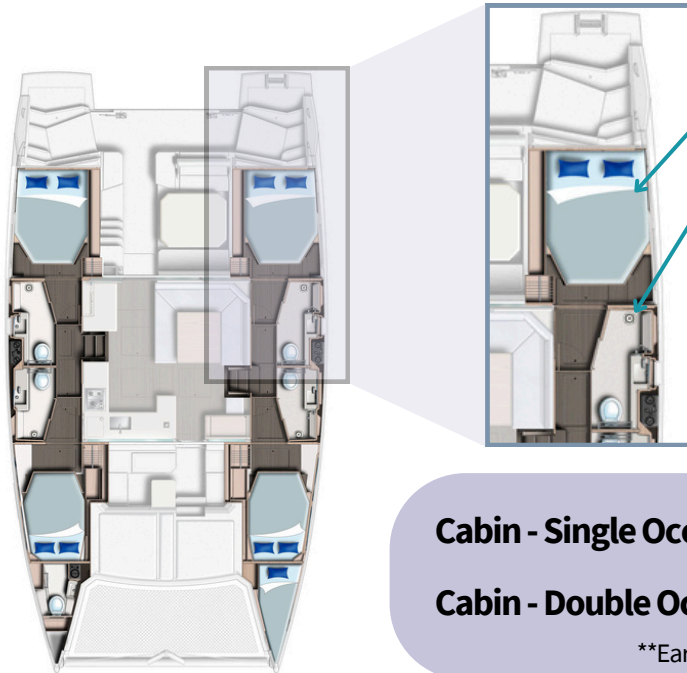

Cabins:

- Queen size bed
- Private Bath for each cabin
- Air Conditioning
- Overhead roller blinders for privacy and roller bug screens
- Hanging lockers
- Recessed LED lights
- Wifi
- USB ports

Cabin - Single Occupancy: \$9,995** / \$10,750

Cabin - Double Occupancy: \$10,495** / \$11,282

**Early Bird Pricing ends August 31st 2025



Galley:

- Watermaker: 117 liter/31 gallon per hour
- 3-burner gas stove & oven
- Vitrefrigo 2-drawer fridge/freezer 56 gal, 12 volt
- Safe with digital combination lock

Deck:

- Wraparound flybridge lounge
- Beanbag chairs
- Transom shower with hot and cold water mixer
- Davit system with electric winch

Helm/Cockpit:

- Garmin C10 forward facing Camera Raymarine Instrument Package: autopilot display, 9" display, incl. depth & wind transducer
- Fusion Marine Stereo with docking station in saloon. with Bluetooth, USB & AUX connectivity
- Generator – 9 kiloWatt
- Navigation tools: Parallel rule, compass, dividers, binoculars





BOAT 3 - Bareboat

Sunsail 454L Classic 4 Cabin Catamaran

Winner of the 'Best Charter Boat' category in Cruising World's 2017 'Boat of the Year' competition, this innovative mid-size catamaran from renowned boat builders Robertson & Caine takes style, comfort, and performance to the next level. The new Moorings 4500 features four spacious staterooms, all with en-suite baths – and delivers the solid performance expected from this world-renowned line of catamarans, and more – for an unrivaled mid-size catamaran charter experience. The 4500 boasts an interior volume and spaciousness typically found on larger yachts. An updated, sleek exterior design featuring expansive windows also greatly impacts the interior saloon, creating panoramic views.

All the lines return to the raised helm station, fully equipped with electric winches that help ensure maneuvering is trouble-free. With its pedigree as a fast and sturdy catamaran. This impression is enhanced by the choice of state-of-the-art Raymarine navigation instruments and the twin Yanmar 45 HP engines which will provide all the power you will ever need.

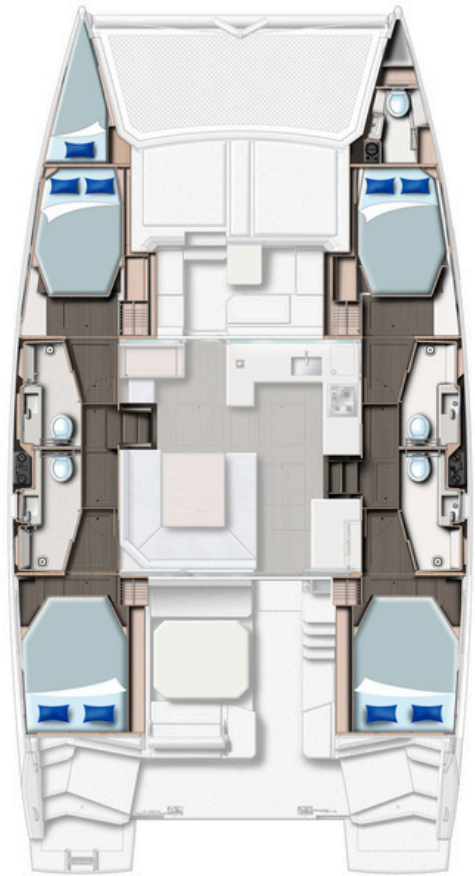

GENERAL SPECIFICATIONS

Length Overall:	45 ft 0 in
Waterline Length:	42 ft 11 in
Beam:	24 ft 2 in
Draft:	5 ft 1 in
Displacement:	31967 lb
Fuel Capacity:	185 gal
Water Capacity:	206 gal
Engines:	2 x Yanmar 45hp sail drives

Bareboat Sunsail 454L Classic 4 Cabin Catamaran

Sleeps 2-10 \$21,995** / \$23,645

**Early Bird Pricing ends August 31st, 2025.





BOAT 4 - Bareboat

Sunsail 424/4/4 Premier Catamaran

Cruise in style and luxury while enjoying the scenic views through wrap-around windows. The roomy interior features a skylight, U-shaped forward-facing galley, island berths for dual-sided access to the bed, and a forward door for ease of movement around the yacht. The Sunsail 424 also includes additional features such as underwater lights, a generator, fitted cushions and a water purifying system.

The perfect balance of cruising performance and onboard comfort is achieved in this next-generation catamaran. The separate helm station is protected behind the main saloon bulkhead with all controls leading there, which makes single-handling this yacht a breeze for adept skippers. Stepped hulls and powerful rig with overlapping genoa allow for safe and spry maneuverability in varying wind conditions.

**Bareboat Sunsail 424
4/4 Premier Catamaran**
Sleeps 2-9 \$21,195** / \$22,785



**Early Bird Pricing ends August 31st, 2025.

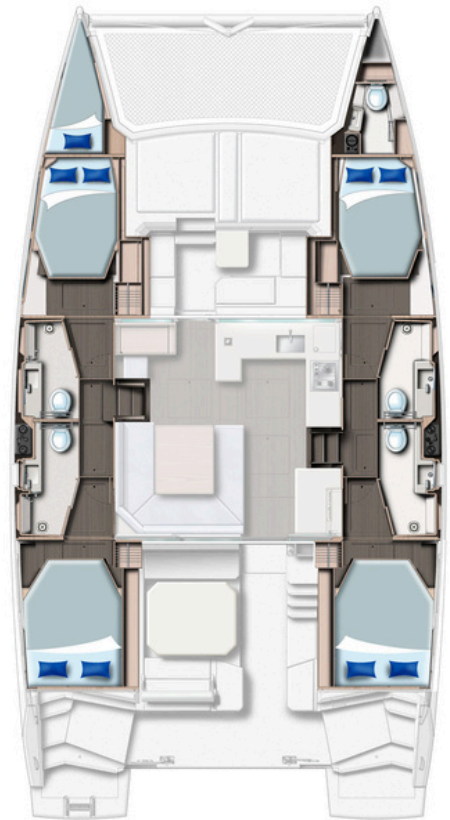



BOAT 5 - Bareboat

Sunsail 41-3 Cabin Classic Monohull

With her sturdy hull and numerous onboard comfort features, the Sunsail 41.0 from the Jeanneau Sun Odyssey range is a modern marvel for enjoyable sailing.

This 3-cabin, 2-head monohull offers stability under sail and innovative ease of movement around the boat.

The contemporary design of the Sunsail 41.0 features many live aboard comforts including the fully-equipped, spacious central galley and relaxing convertible salon, both with ample storage. Generous amounts of natural light create a spacious and bright interior. Her sleek lines and cruising comforts appeal to those who choose to sail in style.

From the cockpit, the dual helm station allows you to be in complete control. With centralized winches and repositioned bow, the Sunsail 41.0 performs at optimal speed with decreased drag. The expertly laid out deck features a lower boom for easy access.



**Bareboat Sunsail 41-3
Cabin Classic Monohull**
Sleeps 2-6 \$11,495** / \$12,357



**Early Bird Pricing ends August 31st, 2025.



GENERAL SPECIFICATIONS

Length Overall:	40ft 5 in
Waterline Length:	36ft 1 in
Beam:	13ft 1 in
Draft:	6ft 10 in
Displacement:	16,424 lb
Fuel Capacity:	53 gal
Water Capacity:	140 gal
Engines:	2 x Yanmar 45hp sail drives



TRAVEL ARRANGEMENTS

The flights to Phuket, Thailand from California take at least 20 hours, including at least one layover. Pricing is presently running approximately \$900 to \$2,000 per person. If you would like to use a travel agent to book your flights, we suggest Bob Entwisle at E&E Travel. Plan on arriving at least one day early to prevent missing cast-off due to any travel delays. And also consider spending a few extra days at the conclusion of the voyage, there are many lodging options available around the Eden Island Marina.

Key points:

- IATA airport code: **HKT** (Phuket International Airport)
- Moorings Arrival Time: **9am, March 19th 2026**
- Moorings Departure Time: 10am, March 28th 2026
- Transfers: Local taxis or pre-arranged marina shuttles approximate cost
 - 800 Baht each way for up to 4 passengers,
 - 950 Baht each way for up to 6 passengers
 - 1100 Baht each way for up to 8 passengers.

Ao Po Grand Marina
113/1 Moo 6
Tambon Paklok Amphur Thalang
Phuket 83110
Thailand



Bob @ E&E Travel
(415) 819-5665
bobetravels@gmail.com



Other Travel Considerations

REQUIREMENTS FOR ENTRY

- Passport
- Travel Authorization (see below)
- Sufficient funds and confirmed accommodation

Customs

Prohibited items and those items requiring permits include:

- pharmaceuticals (see next page)
- tobacco
- alcohol
- radio equipment
- fruits or vegetables



Travel Authorization for Thailand

For your Phuket, Thailand flotilla, please be aware of the following entry requirements. Most nationalities do not require a visa for short tourist stays in Thailand (typically up to 30 days when arriving by air). However, always check the specific visa requirements for your nationality with the Royal Thai Embassy or Consulate in your country well in advance of your trip. Visa policies can change, and requirements vary.

To ensure a smooth entry into Thailand, you should generally have the following:

- A valid passport: Your passport should be valid for at least six months beyond your planned date of departure from Thailand.
- Proof of onward or return travel: This could be your airline booking confirmation clearly showing your departure from Thailand.
- Proof of accommodation: While a specific "Travel Authorization" portal like the Seychelles doesn't exist for general tourist entry, immigration officials may ask for your accommodation details. Be prepared to show your boat charter information or any pre-booked hotel stays.
- Sufficient funds: You may be asked to demonstrate that you have sufficient funds for your stay in Thailand (e.g., cash or credit cards).

While there isn't a pre-arrival "Travel Authorization" like the Seychelles system for most tourists, Thailand occasionally implements specific entry requirements or digital forms, especially after global events.

Always check the official website of the Royal Thai Embassy or Consulate in your country, or the Thai Ministry of Foreign Affairs, for the most current and specific entry information before your travel. This is crucial to ensure you have all necessary documents and meet any updated requirements.



Medication Import Guidelines for Thailand

If you're bringing medication to Thailand, here are some key guidelines to keep in mind:

- **Authorization May Be Required:** You might need prior authorization from the Thai Food and Drug Administration (FDA) for certain controlled drugs or unapproved medicines. It's always best to check if your specific medication falls into this category before you travel.
- **Medical Justification:** Always carry a valid prescription or a medical certificate from your licensed doctor. This document should clearly state that the medicine is necessary for your health or a life-saving purpose.
- **Quantity Restrictions:** Generally, you should limit the imported quantity to what's needed for personal use, typically not exceeding a 30-day supply. For larger quantities, or if you're on a longer trip, it's crucial to get prior approval.
- **Required Documentation:** Be sure to have comprehensive documentation. This includes details of the medicine's name, dosage, the duration of your treatment, and your prescribing physician's credentials. Keep all medications in their original packaging with clear labels.



It's a good idea to consult the Royal Thai Embassy or Consulate in your country, or the Thai FDA website, for the most up-to-date and specific regulations regarding your medications.

Local Standards

Language

While Thai is the official language of Thailand and the primary language spoken throughout the country, you'll find that English is widely understood and spoken in Phuket and across the popular tourist areas of the Andaman Sea. Many locals working in hospitality, tourism, and various businesses will have a good grasp of English.

Phone Service

For easy and affordable connectivity, local SIM cards are readily available for tourists at airports, convenience stores, and mobile provider shops. You can use these with your unlocked, compatible cell phone. Before you travel, it's a good idea to check with your current carrier to ensure your phone is unlocked and will work in Thailand.



Country Prefix
+248

Local Emergency
Number
999

Conversion Rate

\$1 US ->
32.37 THB

100 THB -> \$
3.09 US

as of 7/1/25

Currency

The official currency of Thailand is the Thai Baht (THB). While it's always best to use Baht for most transactions, in some larger tourist-focused establishments in Phuket and other major Andaman Sea destinations, you might find that U.S. dollars or other major currencies are accepted, though usually at a less favorable exchange rate.

ATMs are widely available at airports, in cities like Phuket, and across major tourist islands in the Andaman Sea. They dispense Thai Baht. Credit cards are generally accepted in larger hotels, restaurants, and retail stores, especially in tourist hubs. However, for smaller shops, local markets, street food vendors, and more remote areas, cash is king. It's always a good idea to have a supply of Thai Baht on hand for everyday expenses, particularly when you're exploring off the beaten path or making smaller purchases.



What To Bring

Passport

We will be traveling to Seychelles. **No visa is required.** Visitor permits are granted upon arrival with a return ticket, but an **electronic Travel Authorization will be required prior to entry.** Please ensure your passport is current and will not expire for at least six months after the conclusion of trip.

Luggage

We suggest traveling light. Your gear should fit in a medium duffel bag and a small carry-on bag. Your carry-on should be less than 15 pounds. We recommend using a dry bag or backpack. Both bags should be collapsible for easy stowage on the boat in a small space. Do not bring bags with hard frames as they are difficult to stow.

Gear

We have found that people often only use about half of what they bring. A great way to bring only what you use is to lay all your items out and reduce it by 50%. Lay them out again and then reduce again. Gear weight depends on weather conditions of course, but lightweight layering pieces made of moisture-wicking fabric that will dry quickly is essential. Your total gear weight should be less than 55lbs, including carry-on.

Sun conditions can be very different than in San Francisco Bay. Consider lightweight clothing that covers exposed areas without adding bulk or weight. There are a variety of lightweight pants, shirts, and blouses that provide UV protection. Sunscreen and hats are essential.

What Not to Bring

Different states and countries have different travel rules, regulations, and considerations. If you have specific questions about an item, ask us. Some general items you should not bring are illegal drugs, weapons, hair dryers, expensive jewelry, pets, rigid suitcases, surfboards, golf clubs (it has happened), fireworks, and dive tanks. Linens, towels, and pillows are provided on each boat and are not necessary to bring.

Considerations

The charter base will typically provide fins, but we encourage you to bring your own mask and snorkel. There are PFDs (life jackets) provided onboard the boat, however, you are more than welcome to bring your own. Note, you'll need to check with your airline on their rules when it comes to traveling with an inflatable PFD.





Galley And Provisioning

Provisioning for your flotilla adventure will be a key discussion point at our initial crew meeting.

Initial Provisioning (Club Boats): For our club boats, initial menus for staples, breakfast, lunch, and snacks will be arranged in advance through The Moorings charter company and are included in the cost of your trip. This helps ensure a smooth start to your journey.

Bareboat Skippers: We'll provide dedicated assistance to our bareboat skippers in planning and organizing their provisioning needs.

Final Provisioning at Ao Po Grand Marina: Final provisioning will be completed once we arrive at the Moorings charter base in Ao Po Grand Marina, Phuket. This convenient location offers easy access to supplies. The area around Ao Po Grand Marina, and Phuket in general, boasts several full-service markets and a variety of smaller shops for all your provisioning needs. Supermarkets are typically open daily. You can pay with Thai Baht (THB), and credit cards are generally accepted at larger stores, though cash is always good to have on hand for smaller vendors.

Meals Ashore & Additional Provisions: Your crew will decide on how many meals you plan on eating ashore and provision accordingly. Food and beverage costs will vary based on your individual crew's desires. Any additional meals will be decided upon and purchased collectively by the crew, depending on tastes and preferences.

We understand that personal beverage preferences (including alcohol) vary, so dedicated provisioning time will be provided for crew members to make their own purchases. One or two crew members will typically be assigned to stowing the provisions to help organize everything on board.

Galley Duty & Schedules: While galley duty is a shared responsibility, those who help inventory the provisions can also assist others in finding stored items. Each boat will establish its own cooking and cleaning schedules based on crew expectations and experience, ensuring a harmonious and enjoyable time for everyone on board.





Galley And Provisioning (continued)

Special Dietary Needs

The Trip Leader and skippers will consult with participants at the crew meeting regarding advanced provisioning. This is your opportunity to let them know if you have specific dietary needs or restrictions. We can plan to accommodate you. If there are unique items you desire, you will have time to purchase them during the provisioning trip.

Breakfast

Breakfast will typically be between 7:00 AM to 9:00 AM each day on club boats, with flexibility based on the itinerary, group, and individual desires. We have enjoyed full course breakfasts, complete with bacon, eggs, et cetera. We have also enjoyed granola bars and fruit, depending on the crew. The goal is to meet your needs so you will have energy to enjoy the rest of your day.



Lunches

Lunches are very casual with no set schedule. They can be soup and sandwiches, salads, veggie sticks, or local fare. Lunch is often served under way and conditions may dictate what we have on a particular day. If the crew agrees, and a nice lunch spot is found, we can dinghy ashore to eat at a local restaurant or picnic on the beach.



Snacks

Snacks are always a very personal thing and whatever the crew desires. Sometimes they can be chips and salsa or cheese and crackers. Fresh fruit and nuts are always good (and delicious), as they require little to no preparation and help maintain energy.

Dinners

Dinners provide the most flexibility. We can choose to relax on board, cook and watch the sunset, or go ashore and sample the local culture and cuisine. When we make provisioning plans, at least one dinner meal on board needs to be included so that if we find a secluded anchorage and decide not to move, we can remain to enjoy the peace and serenity.

Dinner Ashore

If we choose to go ashore in the evening, meal costs will be the responsibility of each person. Usually, most establishments will be willing to split checks. Be sure to carry some cash with you as small "mom and pop" places only accept cash.

Perishables

Over the years, we have discovered that some items have a very short shelf life in the marine environment. We will try to anticipate this by acquiring the fewest possible perishables and restock enroute. Often, we come across fresh fish on the docks or at open markets. There is nothing as delicious as fresh seafood caught that very day.

